



TINY HOMES & CABINS

Ideal for compact living, farm diversification, back gardens and glamping sites.



Standing proudly apart



Every cabin we meticulously craft is not just a structure—*it's a statement.*

At the core of our design philosophy is a profound respect for human health by meticulously selecting non-toxic materials, glues, solvents, and paints, crafting breath-easy abodes that prioritise vitality and wellness.

Our designs draw inspiration from the unyielding beauty of nature, employing natural wood finishes and bountiful natural lighting, inviting the outdoors in to foster a serene communion with nature.

The Future is Sustainable: Beyond mere aesthetics, our cabins are a declaration of our commitment to the planet. By ingeniously minimising water and electricity consumption, we empower you to significantly reduce your carbon footprint, contributing to a gentler, more respectful interaction with our Earth.



Exclusive to us

Unique designs to break the mould

UNMATCHED AFTERCARE

Our aftercare package is unmatched in the industry, offering 2 years of guaranteed remedial work, 10 years of maintenance support, and an annual report showcasing energy and water savings with a full Carbon calculation.



LONG LASTING - LOW MAINTAINENCE

Built to housing standards surpassing BS3632:2023 to ensure a long life cabin for a longer yield and less time repairing shorter lifespan models.

LOOKS DIFFERENT / FEELS DIFFERENT

The architecturally designed cabin offer a timeless marvel, future-proofed for luxury-seeking, experience-driven generations. Each lodge provides an oasis of serenity with unrivalled soundproofing, ensuring peace and tranquillity even with neighbouring cabins in close proximity.

STAND OUT WITH GREEN TECHNOLOGY

Air Source Heat Pumps provide low-energy heating and cooling all year round.

MVHR System removes moisture and dust from inside the home creating healthy air and reducing mold.

Non Toxic glues, paints and silicones for allergy and asthma sufferers.

REDUCE BILLS

Our lodges pair beautifully with Solar PV for self-sufficiency for up to 80% of the year.

Additionally, our aerated showerheads reduce water consumption by up to 40%



Betula

18sqm

1 bedroom cabin

£51,500

Excluding delivery

Escape to nature with the Betula - our beautifully crafted 1 bedroom cabin that's inspired by the natural beauty of birch wood.

With an all-wood interior that showcases the unique character and warmth of this iconic wood, you'll feel at one with nature from the moment you step inside.

Take in the panoramic views of the surrounding beauty through the large feature window and double glass doors, which also flood the space with natural light. From the bespoke fitted kitchenette to the bed frame and seating area, every detail has been carefully considered to ensure maximum comfort and functionality.

The exterior of the Betula is equally stunning, with birch wood panels and jet-black paint that blends seamlessly into the surrounding trees. The addition of decking creates the perfect space for outdoor dining and relaxation, surrounded by the bounty of nature.

The Betula also includes a composting toilet, single cubicle shower, and vanity and sink, so you can enjoy a comfortable and eco-friendly stay in nature. Experience the ultimate in rustic luxury with the Betula - order yours today and immerse yourself in the beauty of nature like never before.





3.2m W x 6.4m L



The Details

External Dimensions 3.2m W x 6.45m L x 3.05m H

Internal Height 2.7m

Exterior larch cladding painted black

Interior real wood wall panelling (birch plywood, wood panels or white walls)

Bespoke wood bedframe for a kingsize bed

Bespoke fitted seating area

600mm sink unit, 400mm 3 drawer unit, 400mm cupboard with a 2 ring hob

Real wood floor and ceiling

Separate composting toilet or flushing toilet, shower and vanity sink and boiler cupboard

Utility

2 person space

Open plan to allow nature into the home

Living area facing double glass doors

Good size kitchenette for light dining

Compact bathroom

Ample natural light

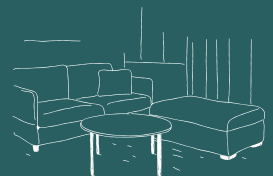

Modern design meets sustainable build practices

BETULA 1BED
£51,500



1 Kingsize bed space
Open plan cabin
Kitchenette
Compact bathroom
Double french doors
Panoramic window
Choice of 'scandi or
Contemporary' finishes



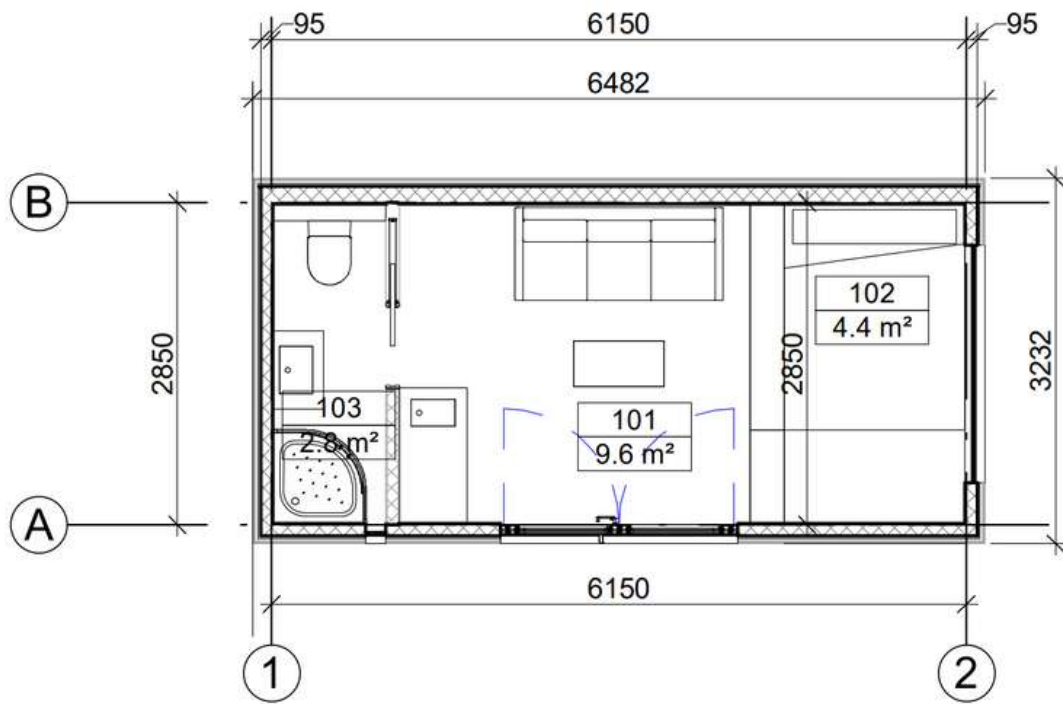

CUSTOMISATION



Thermowood - Natural Finish
 Birch - Anthracite / Black



Wall finish can be white
 Huntonit boards



Composting toilet or flushing toilet



Darwen

20sqm

1 bedroom cabin

£56,500

Excluding delivery

Introducing the Darwen - our ultra-luxurious 1 bedroom cabin that's designed for the most discerning of guests. Whether you're seeking a holiday let, or additional living space for your back garden, the Darwen has everything you need to live in style.

From the moment you step inside, you'll be greeted by its dark and seductive interior, with jet-black walls, cupboards, and detailed finishes that create a moody and sophisticated atmosphere. The real wood ceiling, oak worktops, and stair treads add a touch of warmth and natural beauty, creating a modern and inviting space that's perfect for relaxation.

The bedroom is tucked away underneath the living room, creating a cosy and intimate space that's perfect for a good night's sleep. The living room's stunning panoramic window provides ample natural light and breathtaking views of the surrounding beauty, while the kitchenette offers a two-ring hob and integrated fridge for light dining. Ample cupboards provide plenty of storage space for all your essentials.

Experience the ultimate in tiny home luxury with the Darwen - order yours today and elevate your living experience to new heights!





2.7m W x 6m L



The Details

External Dimensions 2.5m W x 6m L x 3.8m H

Internal floorspace 17.5m²

Internal Height 3.6m

Black Hutonit wall panels with plywood window surrounds

1 kingsize bedroom

Livingroom upstairs with panoramic window

Open plan kitchen with sink and intergrated fridge

Long-wear laminate flooring

Separatt composting toilet, shower and vanity sink

Utility

Cosy kingsize bedroom under living room

Living room with space for sofa bed for sleeping

Kitchen with space for a dining table

Compact bathroom

Double wardrobe and kitchen storage

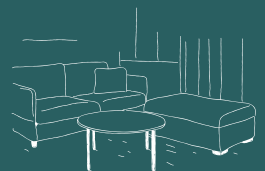

Modern design meets sustainable build practices



Video walkthrough of this model via our website

DARWEN 1 BED £56,500



1 kingsize bedroom
Open plan kitchen
Compact bathroom
Living room (upstairs)
Storage area
Luxury finishes

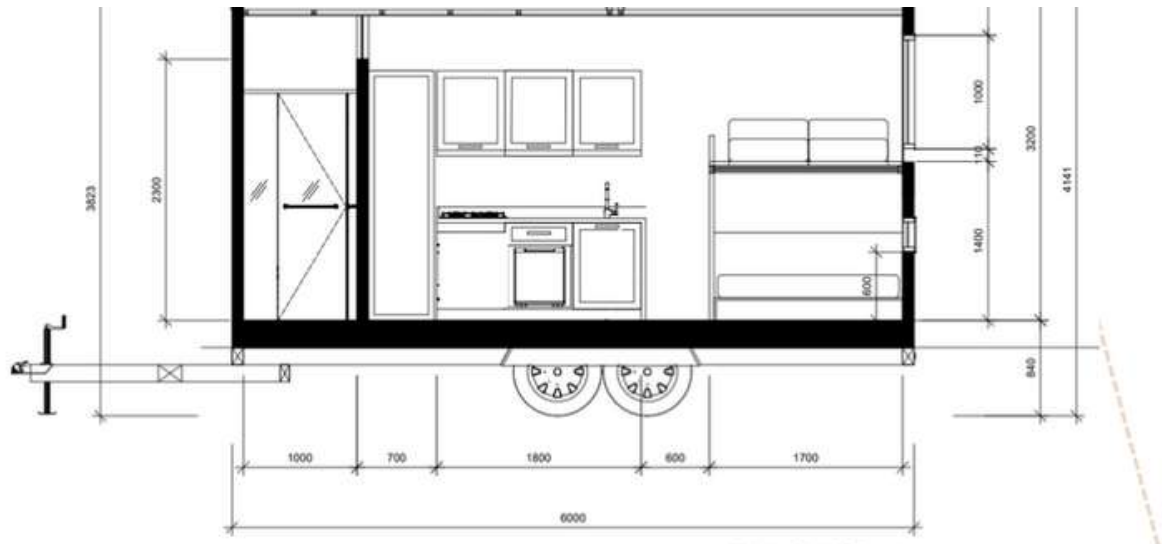

CUSTOMISATION



Thermowood (natural finish)
or spruce cladding in
Anthracite



Choice of black or white
Huntonit board or
plywood wall finish



Composting or flushing toilet

Power & Services

What should I prepare for the installation?

Every project is unique with our customers as far as the North of Scotland to the South tip of England. Each land may require different access and siting solutions which is why we arrange a siting consultation prior to the delivery of your home to ensure you are ready for your delivery.

What is placed under my home?

Included in the price are ground pads, ground screws or a bespoke trailer to ensure we can cater the delivery to your type of land. Ground screws make the home more permanent whereas pads and trailers allow the home to be easily moved should you require this.

How do I access services?

Our models are plug in and play with a 32AMP hook-up and water inlets ready for a food grade hose to connect from your chosen water connection.

How about water?

Wastewater pipes are prepared under the home for you to connect to a sewer or soak away. We use composting toilets to remove black water from the system. Pair your model with eco friendly products for a home that is kind to your environment.

What planning do I need?

Our models fit within the caravan act, conforming and exceeding BS3632:2015 that not only reduces your VAT cost, but allows the models to work within tried & tested planning routes.

Each and every plot is different, and we'll do our best to advise you on the right route for planning, however we do advise you to speak with the local council and/or a planning consultant.

OUR ECO-FRIENDLY MATERIALS & CERTIFICATIONS



HUNTONIT
Malte tak- og panelplater

Wall Boards

BREEAM® NOR

Fibo

Bathroom Wall Panels



STEICO

Woodfibre Underlay



WOLFIN®
BAUTECHNIK

PVC Roofing Membrane



SIGA  1966

Vapour Barriers, Tapes & Membranes



 **TIKKURILA**

Ultra-low VOC, super-hard wearing, allergy-friendly paints



THC
THE TINY HOUSING CO

Team of certified expert architects, engineers & tradespeople build our models



TECHNICAL INFO

Holiday Cabins

Materials	Our unique Specification	Typical 'Cabin'	The Benefits of our Specification
Wall	Isover KL - 0.31W/mK (12% better than rockwool) <ul style="list-style-type: none">• 200mm Wall• 250mm Floor• 250mm Roof	Rockwool - 0.35W/mK <ul style="list-style-type: none">• 100mm Wall• 100mm Floor• 150mm Roof	Heat retains for longer Lower energy and heating bills Improved sound absorption
Glazing	Thermowood Cladding 30-60 year lifespan. Metal Standing Seam 50 year lifespan.	Composite Cladding 20-25 year lifespan. Timber cladding or felt / shingles.	Designed to last a lifetime Minimal maintenance No chemicals or plastics used
Membrane	SIGA Majcoat 150 Membrane with Siga Wigluv tape. (used in all Passive Haus homes)	Basic housewrap, with minimal insulative value or low air-tightness ability.	Eliminates draughts Fully watertight and breathable structure Heat retains for longer
Structure	C24 Structural Timber <ul style="list-style-type: none">• 200mm Wall• 250mm Floor• 250mm Roof	C16 Structural Timber 100-150mm Wall 100-150mm Floor 100-1500mm Roof	C24 is the superior to C16 in terms of strength, resilience with less defects. Thicker walls means additional insulation for a better performance.
VCL	SIGA Majpell® 5 Vapour Control Layer with Siga Rissan Tape. (used in all Passive Haus homes)	Tyvek or other membrane with basic tape for minimal airtightness.	Create an airtight layer to help with vapour control
Windows & Doors	Windows - Triple Glazing 0.9W/mK (U-Value) Doors - Triple Glazing 0.9W/mK (U-Value)	Windows - Double Glazing 1.2-1.6W/mK Doors - Double Glazing 1.2-1.6W/mK	U-values measure how effective a material is as an insulator. The lower the U-value, the higher performing the windows will be.
Mechanical & Heating	MVHR - Superior airflow & recuperation Air source heat pump - cooling & heating ability	Air vents and membranes - no MVHR No heat pumps. Usually gas heating or wood burner.	MVHR provide cleaner air and reduce condensation. Air source heat pumps provide energy efficient heating and cooling.